

Technical training.
Product information.
G16 Complete Vehicle.



BMW Service

Edited for the U.S. market by:
BMW Group University
Technical Training

ST1914

8/1/2019

General information

Symbols used

The following symbol is used in this document to facilitate better comprehension or to draw attention to very important information:



Contains important safety information and information that needs to be observed strictly in order to guarantee the smooth operation of the system.

Information status: June 2019

BMW Group vehicles meet the requirements of the highest safety and quality standards. Changes in requirements for environmental protection, customer benefits and design render necessary continuous development of systems and components. Consequently, there may be discrepancies between the contents of this document and the vehicles available in the training course.

The information contained in the training course materials is solely intended for participants in this training course conducted by BMW Group Technical Training Centers, or BMW Group Contract Training Facilities.

This training manual or any attached publication is not intended to be a complete and all inclusive source for repair and maintenance data. It is only part of a training information system designed to assure that uniform procedures and information are presented to all participants.

For changes/additions to the technical data, repair procedures, please refer to the current information issued by BMW of North America, LLC, Technical Service Department.

This information is available by accessing TIS at www.bmwcenternet.com.

Additional sources of information

Further information on the individual topics can be found in the following:

- Owner's Manual
- Integrated Service Technical Application
- Aftersales Information Research (AIR)

The information contained in this manual is not to be resold, bartered, copied, or transferred without the express written consent of BMW of North America, LLC ("BMW NA").

©2019 BMW of North America, LLC

The BMW name and logo are registered trademarks. All rights reserved.

G16 Complete Vehicle.

Contents.

1.	Introduction.....	1
1.1.	Overview.....	1
1.2.	Dimensions.....	2
1.3.	Silhouette comparison.....	2
1.4.	Weights and payload.....	3
1.5.	Models.....	3
2.	Body Structure.....	4
2.1.	Materials.....	4
3.	Outer Body Skin.....	5
3.1.	Materials.....	5
4.	Doors, Lids and Hatches.....	6
4.1.	Doors.....	6
4.1.1.	Side windows.....	6
4.2.	Trunk lid.....	7
5.	Exterior Trim.....	10
5.1.	Front.....	10
5.2.	Rear.....	11
5.3.	Panoramic glass sunroof.....	13
5.4.	Carbon components.....	14
6.	Interior Equipment.....	16
6.1.	Overview.....	16
6.2.	Center console.....	17
6.3.	Doors.....	18
6.3.1.	Operation.....	18
6.3.2.	Roller sun shades.....	19
6.4.	Rear.....	21
6.5.	Parcel shelf.....	24
7.	Automatic Climate Control.....	25
7.1.	4/3-zone automatic climate control.....	25
8.	Luggage Compartment.....	29
9.	Infotainment.....	30
9.1.	Overview of speaker systems.....	30
9.2.	High-end audio system.....	31
9.2.1.	Wiring diagram.....	31

G16 Complete Vehicle.

Contents.

9.2.2.	Component overview.....	33
9.2.3.	Sound settings.....	34
9.3.	Telematic Communication Box 3.....	36
9.4.	ConnectedDrive.....	37
9.4.1.	Offer structure.....	37
9.4.2.	BMW Live Cockpit Professional.....	38
9.5.	BMW Intelligent Personal Assistant.....	39
9.5.1.	Activation.....	40
9.5.2.	Scope of function.....	40
9.5.3.	Interaction.....	41
9.5.4.	Vehicle expert.....	41
9.5.5.	Assistant.....	41

G16 Complete Vehicle.

1. Introduction.

1.1. Overview

The BMW 8 Series Gran Coupé with the development code G16 extends the BMW 8 Series family. Thanks to the larger vehicle length and the two additional doors, the Gran Coupé offers more space in the rear. The G16 thus combines the sportiness of the BMW 8 Series Coupé with the elegance of a luxury sedan.



G16 Gran Coupé

Since the technical basis of the G16 is identical to that of the G15, this product information describes only the special features of the BMW 8 Series Gran Coupé.

Compared to the G15, the following changes have been made:

- Extended body with four doors
- Panoramic glass sunroof
- Ventilation outlet, USB charging interface and storage in the rear
- Electric roller sun shades
- Grab handles with coat hooks in the rear
- Rear seat bench with a 40:20:40 split and integrated head restraints
- 4/3-zone integrated automatic climate control.

G16 Complete Vehicle.

1. Introduction.

1.2. Dimensions

The exterior dimensions of the G16 in the US version are shown below.

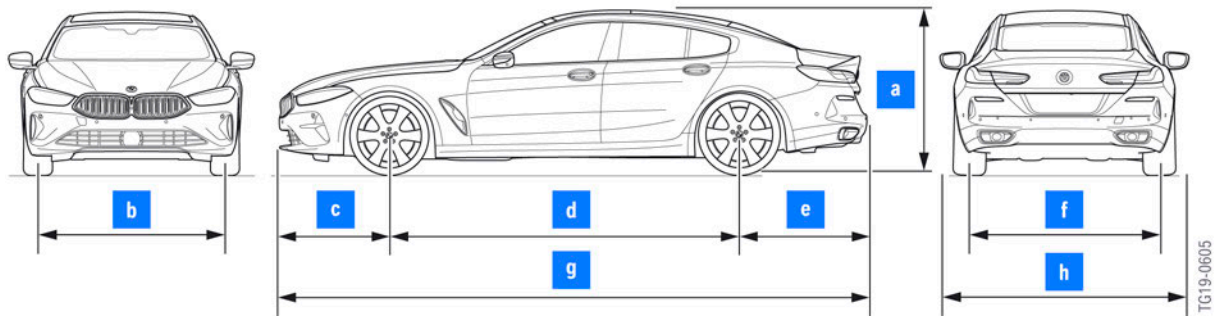

G16 Outer dimensions

Index	Explanation	Unit	BMW 840i xDrive
a	Vehicle height	[mm]	1401
b	Front track width, basic wheels	[mm]	1619
c	Front overhang	[mm]	958
d	Wheelbase	[mm]	3023
e	Rear overhang	[mm]	1103
f	Rear track width, basic wheels	[mm]	1671
g	Vehicle length	[mm]	5084
h	Vehicle width excluding/including exterior mirrors	[mm]	1932/2137

1.3. Silhouette comparison

In the following graphic you can see the silhouette (outline) of the G16 compared with the silhouette of the G15.

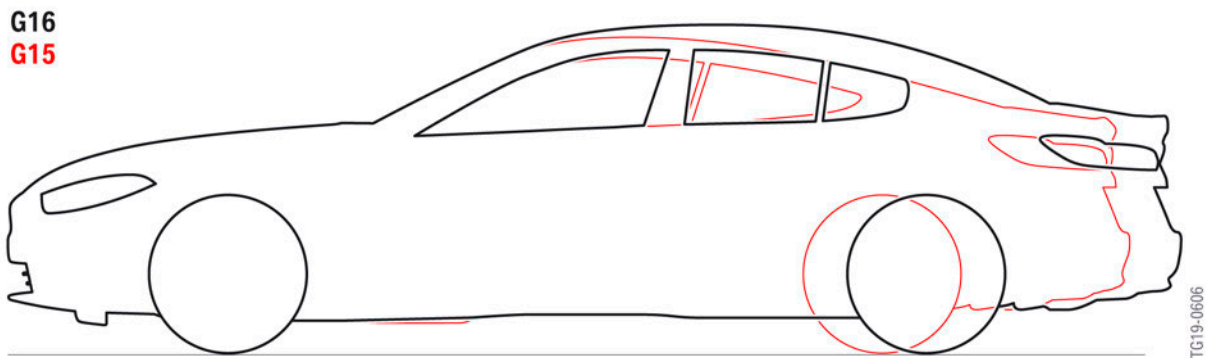

Silhouette comparison of G16/G15

G16 Complete Vehicle.

1. Introduction.

The following table shows the most important data of the G16 and compares this directly with the G15.

	Unit	G16 M850i xDrive	G15 M850i xDrive	Difference
Vehicle height	[mm]	1407	1346	+61
Vehicle length	[mm]	5087	4856	+231
Wheelbase	[mm]	3023	2822	+201
Width excluding exterior mirrors	[mm]	1932	1902	+30
Vehicle width with exterior mirrors	[mm]	2137	2137	0
Vehicle curb weight	[lbs]	4758	4478	+280
Payload	[lbs]	838	772	+66
Luggage compartment volume	[l]	440	420	+20

1.4. Weights and payload

The vehicle curb weights and the payloads of the G16 in the US version are shown in the following table.

Model	Unit	Vehicle curb weight	Payload
BMW 840i	[lbs]	4262	838
BMW 840i xDrive	[lbs]	4381	838
BMW M850i xDrive	[lbs]	4758	838

1.5. Models

The G16 will be available at market introduction with the following models.

Model	Engine	Displacement [cc]	Power output [HP]	Torque [lb ft]
BMW 840i/840i xDrive	6-cylinder gasoline engine	2998	335	369
BMW M850i xDrive	8-cylinder gasoline engine	4395	523	553

G16 Complete Vehicle.

2. Body Structure.

2.1. Materials

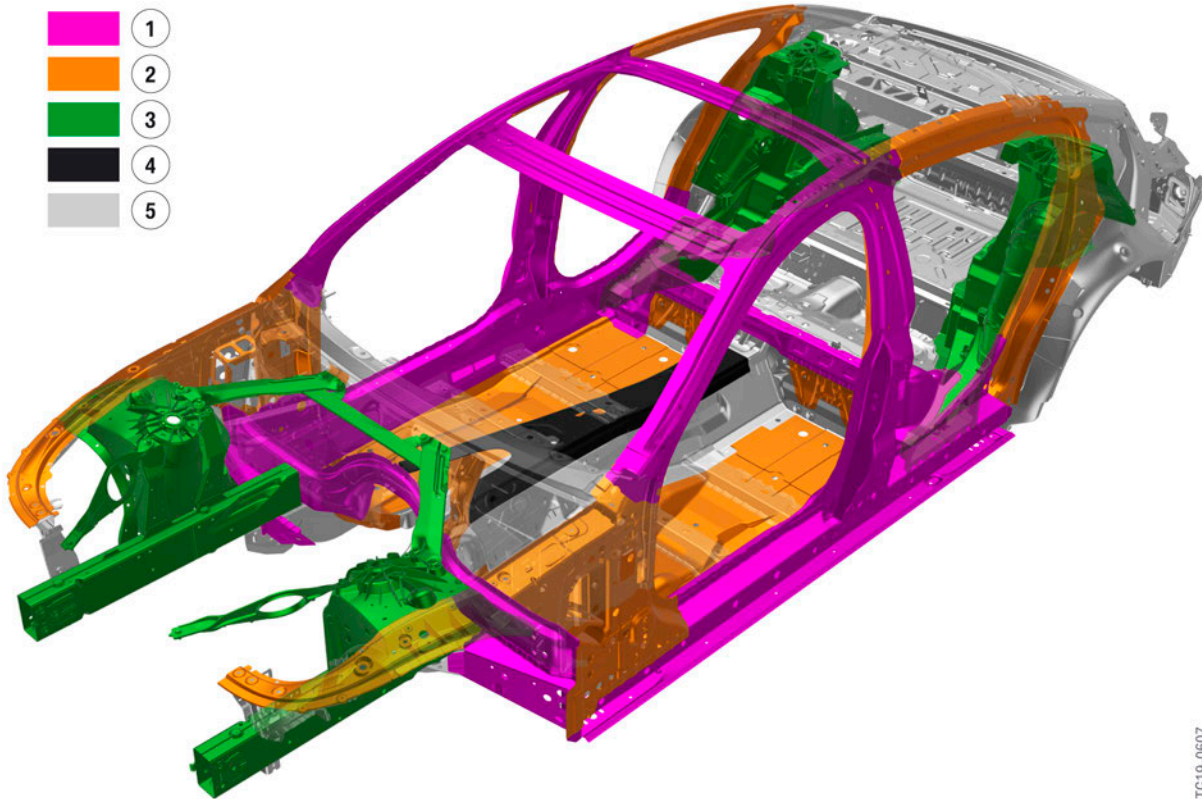

TG19-0607

G16 Material overview, body structure

Index	Explanation
1	Ultra-high strength hot-formed steel (> 900 N/mm ²)
2	Multiphase steel (> 300 N/mm ²)
3	Aluminum
4	Carbon
5	Other steel

As with the G15, the lightweight body concept of the G16 uses components made of high-strength hot-formed steel, aluminum and carbon. Thanks to the material mix, the materials are able to contribute their specific strengths to the vehicle in the best possible way.

The number of aluminum components (die-cast and extruded profiles) has increased considerably compared with earlier BMW vehicles. Thus, for example, the rear side members and spring strut domes are, as in the G15, also made of aluminum.

G16 Complete Vehicle.

3. Outer Body Skin.

3.1. Materials

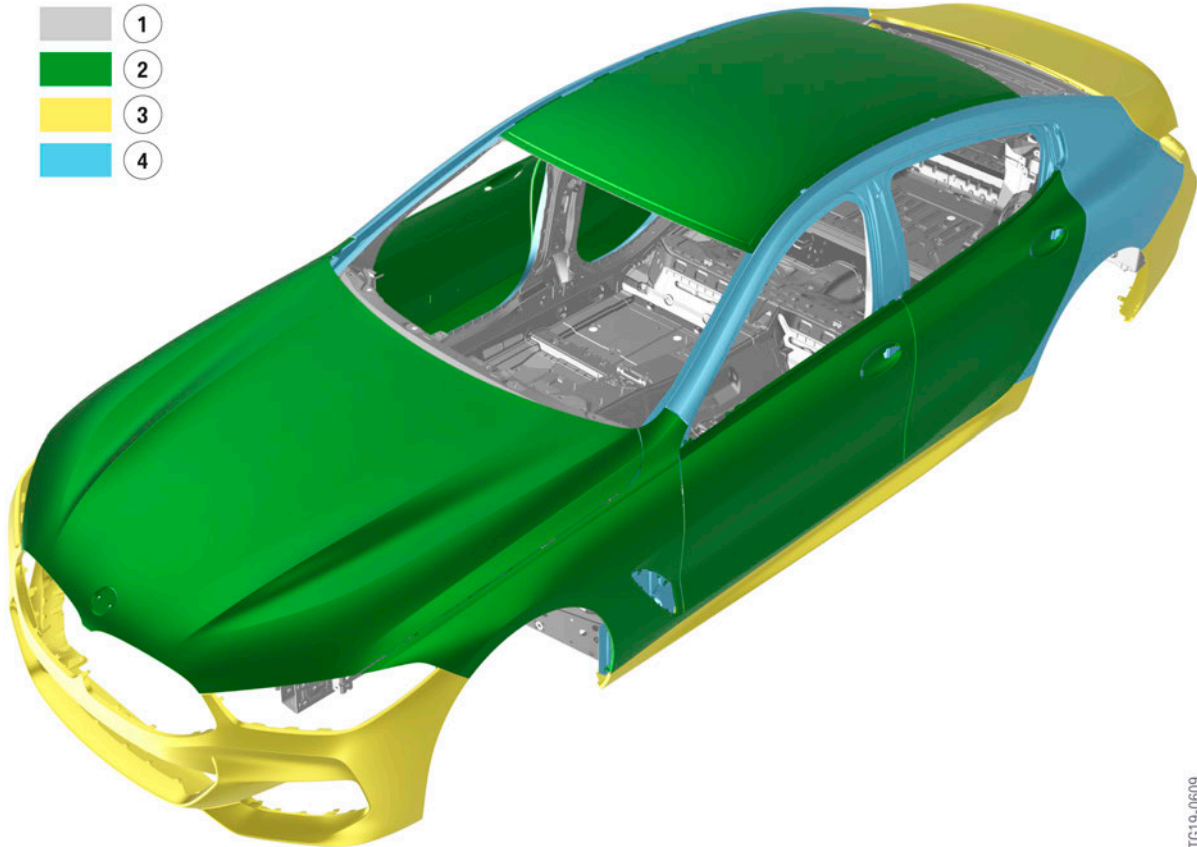

G16 Material overview, outer body skin

TG19-0609

Index	Explanation
1	Other steel grades
2	Aluminum
3	Plastic (SMC, PP, EPDM)
4	Deep drawing steel

G16 Complete Vehicle.

4. Doors, Lids and Hatches.

4.1. Doors

Four frameless doors are installed in the G16. The doors of the G16 are manufactured in an aluminum monocoque construction and are identical in terms of structure to the doors of the G15. The front doors of the G16 are shorter and higher in design than the G15. As in the G15, the doors of the G16 also have a plastic module carrier which divides the interior of the door into a dry side and a wet side. The module carrier is mounted on the door structure by means of screws and bayonet fittings. Sensitive components, such as loudspeakers and airbag sensors, are located on the dry side. The power window motor and the power window mechanism are located on the wet side.

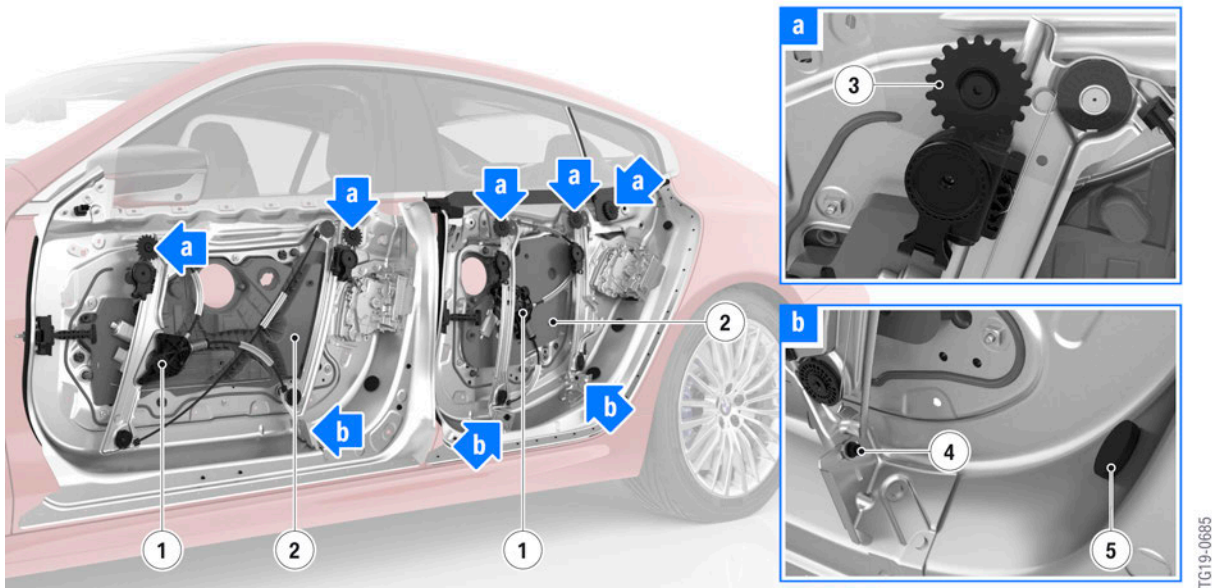

G16 Door module carrier and ranges of side window adjustment

Index	Explanation
1	Power window motor
2	Door module carrier
3	Multi-tooth screw (range of adjustment of side window in z and x direction)
4	Bolts with fastening nuts (range of adjustment of side window in y-direction)
5	Cover (access to the range of adjustment position 4)

4.1.1. Side windows

On the G16 too, the correct adjustment of the front and rear frameless side window is very important. The following characteristics are achieved in the side window area:

- Leak-tightness (avoids wind noise and water ingress)
- Avoidance of rattling and creaking
- No undesired reversing of the side windows during the closing action (anti-trap function).

G16 Complete Vehicle.

4. Doors, Lids and Hatches.

The special tool required to adjust the side window adjustment elements match those of the current BMW coupés.

The current repair instructions must always be observed for the procedure and exact dimensions for correct adjustment work.

4.2. Trunk lid

As on the G15, a trunk lid made of plastic (SMC¹) with a paintable surface is installed on the G16. The IMC method² is being used to manufacture the trunk lid. Additional lining components are not required. This provides more geometrical design freedom and reduces weight.

¹ SMC (Sheet Moulding Compound): plate-shaped, doughy compounds made of thermosetting resins for production of fibre-reinforced plastics.

² IMC (in-mould coating): procedure during which the surface of the shaped part is coated while still in the mould.

G16 Complete Vehicle.

4. Doors, Lids and Hatches.

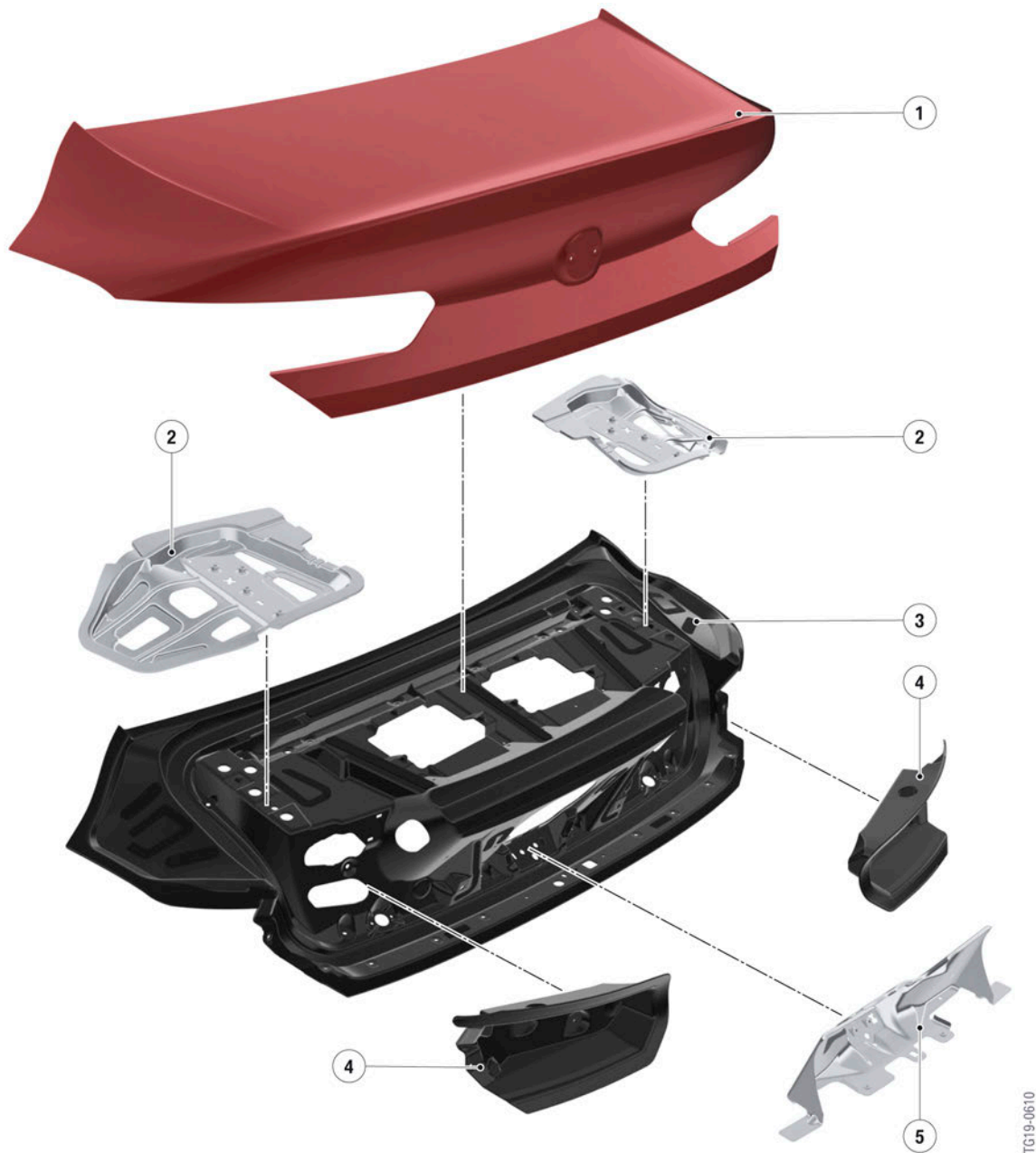

G16 Trunk lid components

Index	Explanation
1	Outer skin (plastic)
2	Hinge reinforcement (steel)
3	Inner shell (plastic)
4	Rear light housing (plastic)
5	Lock reinforcement (steel)

G16 Complete Vehicle.

4. Doors, Lids and Hatches.

As in the G15, the G16 is fitted with automatic trunk lid operation as part of its standard equipment. The structure and location of the drive is identical to the G15.

A soft-close automatic function is used in the trunk lock to lock the trunk lid.



G15 Trunk lid

Index	Explanation
1	Spring support
2	Spindle drive
3	Trunk lock
4	Automatic Soft-close system

G16 Complete Vehicle.

5. Exterior Trim.

5.1. Front

The front end of the G16 is identical to the front end of the G15. It is distinguished from the G15 through a different layout of the surfaces in the area of the BMW radiator grille and the cooling flaps. The front apron of the G16 also features two polished chrome trim strips as part of the standard equipment.



G16 Front

Index	Explanation
1	Trim strip

G16 Complete Vehicle.

5. Exterior Trim.

5.2. Rear

At the rear, original tailpipe trims for the B58 engines are installed in the standard equipment to personalize the G16. A chrome-plated trim strip which visually links the two tailpipe trims is also installed. This trim strip is in three parts.



G16 Rear

Index	Explanation
1	Tailpipe trim
2	Trim strip (three-part)

G16 Complete Vehicle.

5. Exterior Trim.

In the BMW M Performance models the lower section of the rear apron has been exclusively redesigned for the G16 and is not identical to the G15.



BMW M850i xDrive rear

Index	Explanation
1	Lower section, rear apron

G16 Complete Vehicle.

5. Exterior Trim.

5.3. Panoramic glass sunroof

A panoramic glass sunroof is offered exclusively for the G16 as standard equipment (SA 402). The panoramic glass sunroof is made up of two parts. The front glass slide/tilt sunroof can be electrically deployed or slid open. The rear glass sunroof is fixed and cannot be moved.

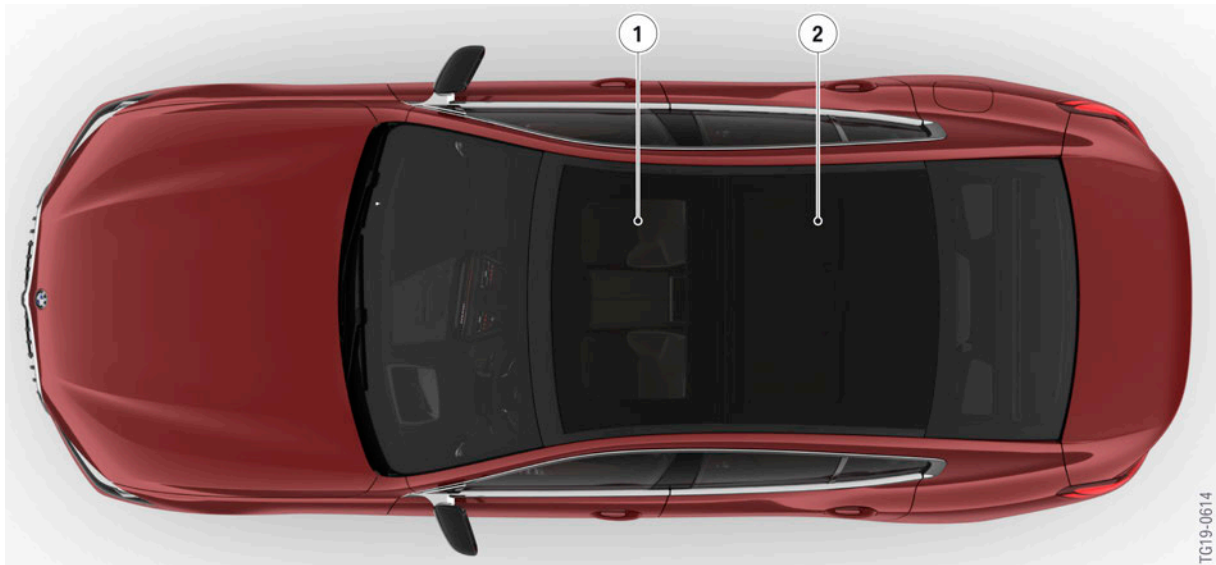

G16 Panoramic glass sunroof

Index	Explanation
1	Glass slide/tilt sunroof
2	Fixed glass roof panel

In the vehicle interior the front and rear glass surfaces are visually separated from each other by the headliner. Both glass surfaces can be covered with a separate electric roller sun shade. The front and rear roller sun shades of the panoramic glass sunroof are controlled from the front seats via the roof function center (FZD). The rear roller sun shade of the panoramic glass sunroof can also be operated by means of a button in the trim panel of the rear door.

G16 Complete Vehicle.

5. Exterior Trim.



Switch for operating the roller sun shade of the G16 panoramic glass sunroof

Index	Explanation
1	Open/close panorama roof roller shade, rear
2	Open panorama roof roller shade, driver/front passenger
3	Close panorama roof roller shade, driver/front passenger

5.4. Carbon components

Various carbon components can be ordered with the optional equipment M Carbon Exterior Package (SA 71C) only available for the M850i xDrive Gran Coupé:

- Air guide element for air curtain
- Trims at the front ornamental grille (omitted in vehicles with front radar sensor)
- Exterior mirror caps
- Carbon trim around tailpipe trims
- Diffuser insert.

G16 Complete Vehicle.

5. Exterior Trim.

An M Carbon Roof can also be ordered with the optional equipment SA 40C. The M Carbon Roof cannot be ordered with the panoramic glass sunroof (SA 402). The M Carbon Roof is only available on the M850i xDrive Gran Coupé.



G16 M carbon roof

G16 Complete Vehicle.

6. Interior Equipment.

6.1. Overview

The interior of G16 in the driver and front passenger area is very similar to the interior of the G15. Only the surface layout of the steering wheel has been altered to electroplated (galvanized).



G16 Interior

Index	Explanation
1	Light operating unit
2	Electroplated (galvanized) trims and buttons
3	Frameless interior mirror
4	Display (integrated automatic heating/air conditioning system)
5	Heating and air conditioning controls
6	Radio operating unit
7	Cover (wireless charging station and cup holder)
8	Selector lever
9	Controller

G16 Complete Vehicle.

6. Interior Equipment.

6.2. Center console

The center console is fitted as part of its standard equipment in the rear with a ventilation outlet containing operating controls and USB ports for charging electrical devices.



G16 Center console in the rear

Index	Explanation
1	Fan unit, rear
2	Type-C USB ports

G16 Complete Vehicle.

6. Interior Equipment.

6.3. Doors

6.3.1. Operation

The switch block in the driver's door has been extended to include buttons to control the power windows in the rear doors.

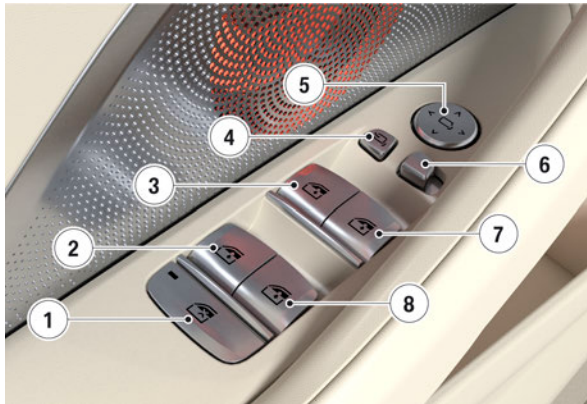

G16 Switch block, driver's door

Index	Explanation
1	Safety switch
2	Left rear door power window button
3	Power window, front left
4	Fold the exterior rearview mirrors in and out
5	Adjust the exterior mirrors
6	Select mirror, Automatic Curb Monitor
7	Power window, front right
8	Right rear door power window button

The rear doors are equipped with a switch for controlling the power windows.



G16 Rear door switch panels

G16 Complete Vehicle.

6. Interior Equipment.

6.3.2. Roller sun shades

Electric roller sun shades are installed in the rear doors with the optional equipment roller sun shades SA 416. The rear doors are equipped with an additional switch panel to control the roller sun shades.



G16 Roller sun shade, rear door

Index	Explanation
1	Open/close roller sun shade, rear left door window glass
2	Power window regulator, rear left door window glass
3	Open/close roller sun shade, rear right door window glass
4	Open/close panoramic sunroof roller shade
5	Open close rear window roller sun shade — all roller sun shades

A button is installed in the driver's door switch block to enable the driver to control the roller sun shades. Pressing the button once opens/closes the roller sun shade of the rear window. Pressing the button for a longer period opens/closes all the roller sun shades.

G16 Complete Vehicle.

6. Interior Equipment.



G16 Button, roller sun shade, driver's side

Index	Explanation
1	Open close rear window roller sun shade — all roller sun shades

Power rear sunshade is standard equipment in the G16 (SA 415).



G16 Power rear sunshade

The power rear sunshade is controlled by means of the corresponding button in the switch panel in the driver's door and the rear doors. Pressing the button once briefly retracts/extends the rear window roller sun shade. Pressing the button for a longer period retracts/extends all the roller sun shades (rear doors and rear window).

G16 Complete Vehicle.

6. Interior Equipment.

6.4. Rear

The G16 is fitted with a 2+1 rear seat bench in the rear. The rear seat bench provides a high degree of comfort for two passengers. The middle seat is only suitable for short trips. The two outer seats are fitted with integrated head restraints. The backrests of the rear seat bench have a 40:20:40 split. Here, the middle section is connected to the left side. When the middle seat is not in use, a center armrest with integrated cup holders can be dropped down. When the middle seat is not in use, a center armrest with integrated cup holders can be dropped down.



G16 Seat bench

Index	Explanation
1	Integrated head restraint
2	Center armrest with cup holder
3	ISOFIX cover cap

The backrests of the seat bench can only be unlocked from the luggage compartment. The backrests are unlocked, as in the G15, mechanically by means of Bowden cables.

G16 Complete Vehicle.

6. Interior Equipment.



G16 Remote backrest unlocking

Index	Explanation
1	Remote backrest unlocking, left
2	Remote backrest unlocking, right

G16 Complete Vehicle.

6. Interior Equipment.

Two grab handles are installed in the headliner for the passengers in the rear. These grab handles have integrated coat hooks.



G16 Grab handle with coat hook in the rear

Index	Explanation
1	Grab handle
2	Coat hook

G16 Complete Vehicle.

6. Interior Equipment.

6.5. Parcel shelf

The parcel shelf of the G16 is, on account of the modified body and the standard equipment roller sun shade (SA 415), not a common part. The luggage compartment is ventilated, as in the G15, via a gap between the parcel shelf and the rear window.



TG19-0622

G16 Parcel shelf

G16 Complete Vehicle.

7. Automatic Climate Control.

The G16 is equipped with a 4/3-zone automatic climate control.

Technically, climate control is split into zones (e.g. driver, front passenger, rear). The first digit represents the individually adjustable temperature settings, whilst the second digit represents the zones in which the amount of air can be individually adjusted.

7.1. 4/3-zone automatic climate control

4/3-zone automatic climate control is standard equipment (SA 4NB). Two temperature zones can be regulated in the driver/front passenger area and in the rear respectively. The amount of air is regulated through two zones in the driver/front passenger area and one zone in the rear.

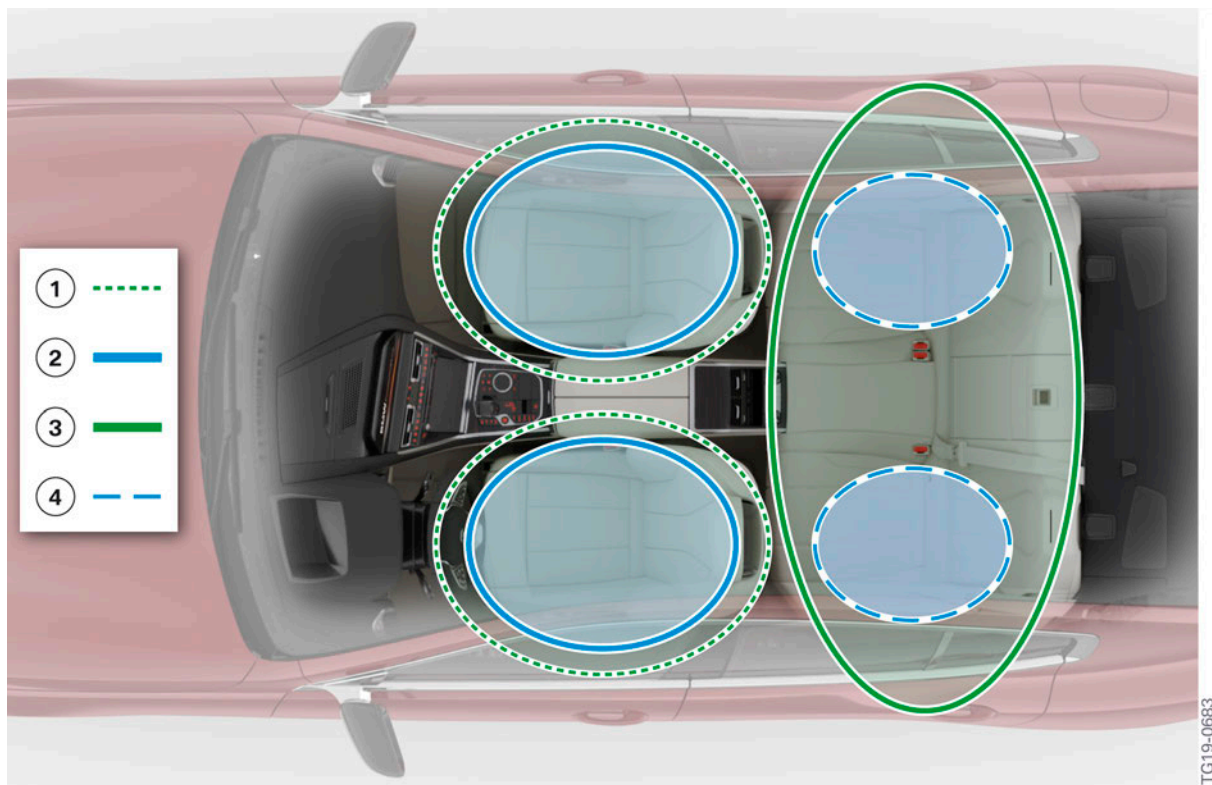

G16 4/3-zone overview

Index	Explanation
1	Air flow control for driver/front passenger
2	Temperature adjustment for driver/front passenger
3	Air flow control for rear passenger compartment
4	Temperature, rear, left/right

The G16 air conditioning control panel for driver/front passenger is a common part and is taken from the G15. The display is designed as a fixed segment display with a glass cover.

G16 Complete Vehicle.

7. Automatic Climate Control.



G16 4/3-zone air conditioning control panel, driver/front passenger

A second air conditioning control panel is installed in the rear. This air conditioning control panel can be used to regulate two temperature zones and one joint amount of air as well as air distribution for the rear.

G16 Complete Vehicle.

7. Automatic Climate Control.



G16 4/3-zone air conditioning control panel in the rear

Index	Explanation
1	Display
2	Seat heating, left
3	Automatic program
4	Temperature adjustment, left
5	Decrease/increase amount of air

G16 Complete Vehicle.

7. Automatic Climate Control.

Index	Explanation
6	Manual air distribution regulation
7	Temperature adjustment, right
8	Max. cooling on/off
9	Seat heating, right

G16 Complete Vehicle.

8. Luggage Compartment.

Two LED lights are additionally installed on the left and right in the G16 luggage compartment. This improves the lighting of the luggage compartment.



G16 Luggage compartment with two additional LED lights

Index	Explanation
1	LED light

G16 Complete Vehicle.

9. Infotainment.

This chapter features only information on the G16 which is not described in the product information for the G15. Further information can be found in the following documents:

- ST1833 — G15 Infotainment
- ST1857 — Infotainment 2018

9.1. Overview of speaker systems

Already at market introduction the G16 comes with two different speaker systems, depending on equipment:

- Top HiFi system (Harman Kardon surround sound system (SA 688))
- High-end audio system (Bowers & Wilkins Diamond surround sound system (SA 6F1))

	Top HiFi (Harman Kardon surround sound system (SA 688))	High-end audio system (Bowers & Wilkins Diamond surround sound system (SA 6F1))
Overall power	464 W	1500 W
Number of diamond tweeters	—	2
Number of tweeters	7	5
Number of mid-range speakers	7	7
Number of bass speakers	2	2
Receiver Audio Module	High	High
Booster	Mid	High
Bus connection	Ethernet	Ethernet

G16 Complete Vehicle.

9. Infotainment.

9.2. High-end audio system

9.2.1. Wiring diagram

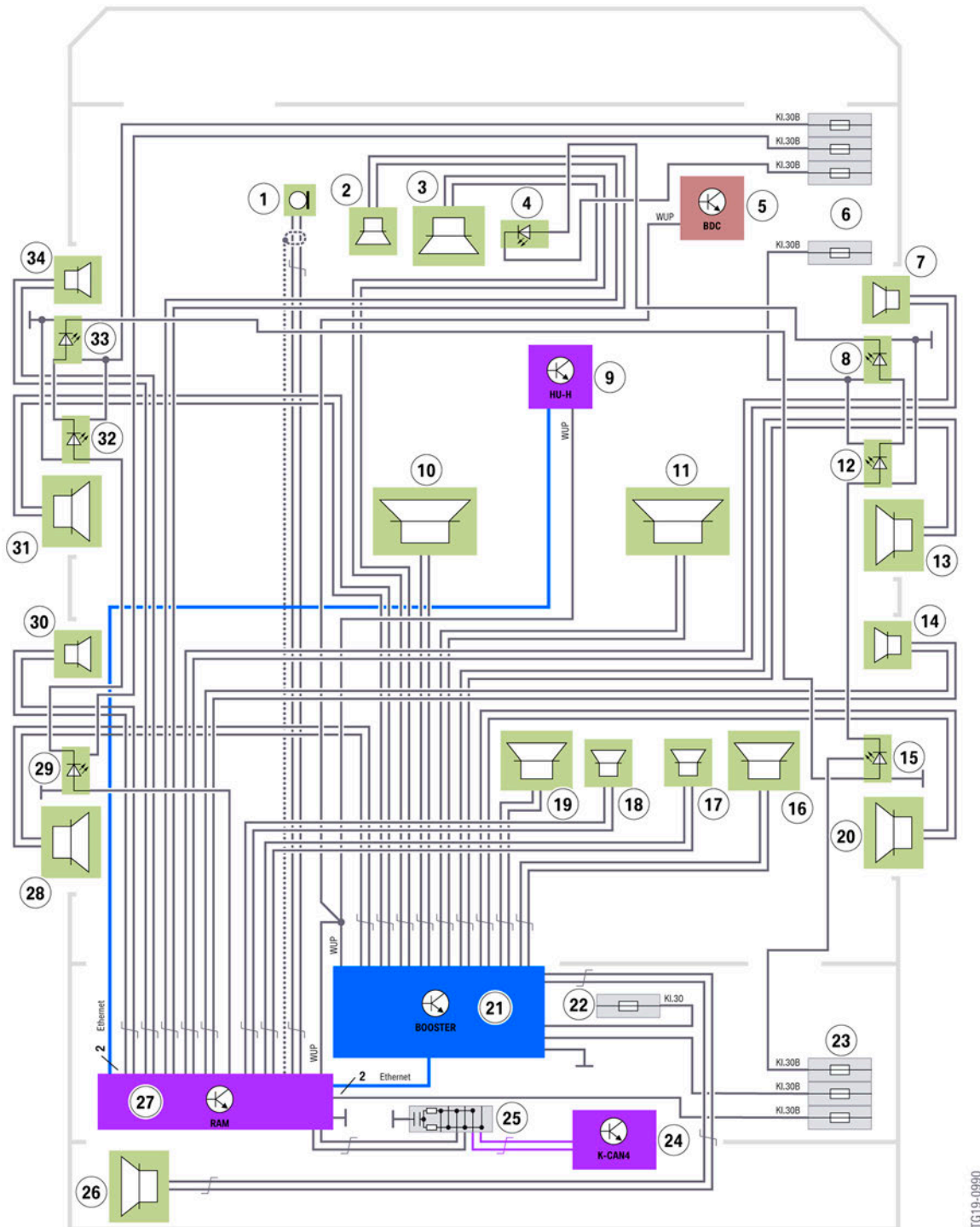

Wiring diagram, High-end audio system

TG19-0990

G16 Complete Vehicle.

9. Infotainment.

Index	Explanation
1	Microphone
2	Tweeter, front center
3	Mid-range speaker, front center
4	LED lights, center stack
5	Body Domain Controller (BDC)
6	Front power distribution box fuses
7	Front right diamond tweeter
8	LED lights, diamond tweeter, front right
9	Head unit
10	Bass speaker, left
11	Bass speaker, right
12	LED lights, mid-range speaker, front right
13	Mid-range speaker, front right
14	Tweeter, rear right
15	LED lights, mid-range speaker, rear right
16	Mid-range speaker, left window shelf
17	Tweeter, right window shelf
18	Tweeter, left window shelf
19	Mid-range speaker, left window shelf
20	Mid-range speaker, rear right
21	Booster
22	Battery
23	Fuses, power distribution box, luggage compartment
24	K-CAN4
25	CAN terminator
26	Speaker for outside sound
27	Receiver Audio Module (RAM)
28	Mid-range speaker, rear left
29	LED lights, mid-range speaker, rear left
30	Tweeter, rear left
31	Mid-range speaker, front left
32	LED lights, mid-range speaker, front left
33	LED lights, tweeter, front left
34	Front left diamond tweeter

G16 Complete Vehicle.

9. Infotainment.

9.2.2. Component overview

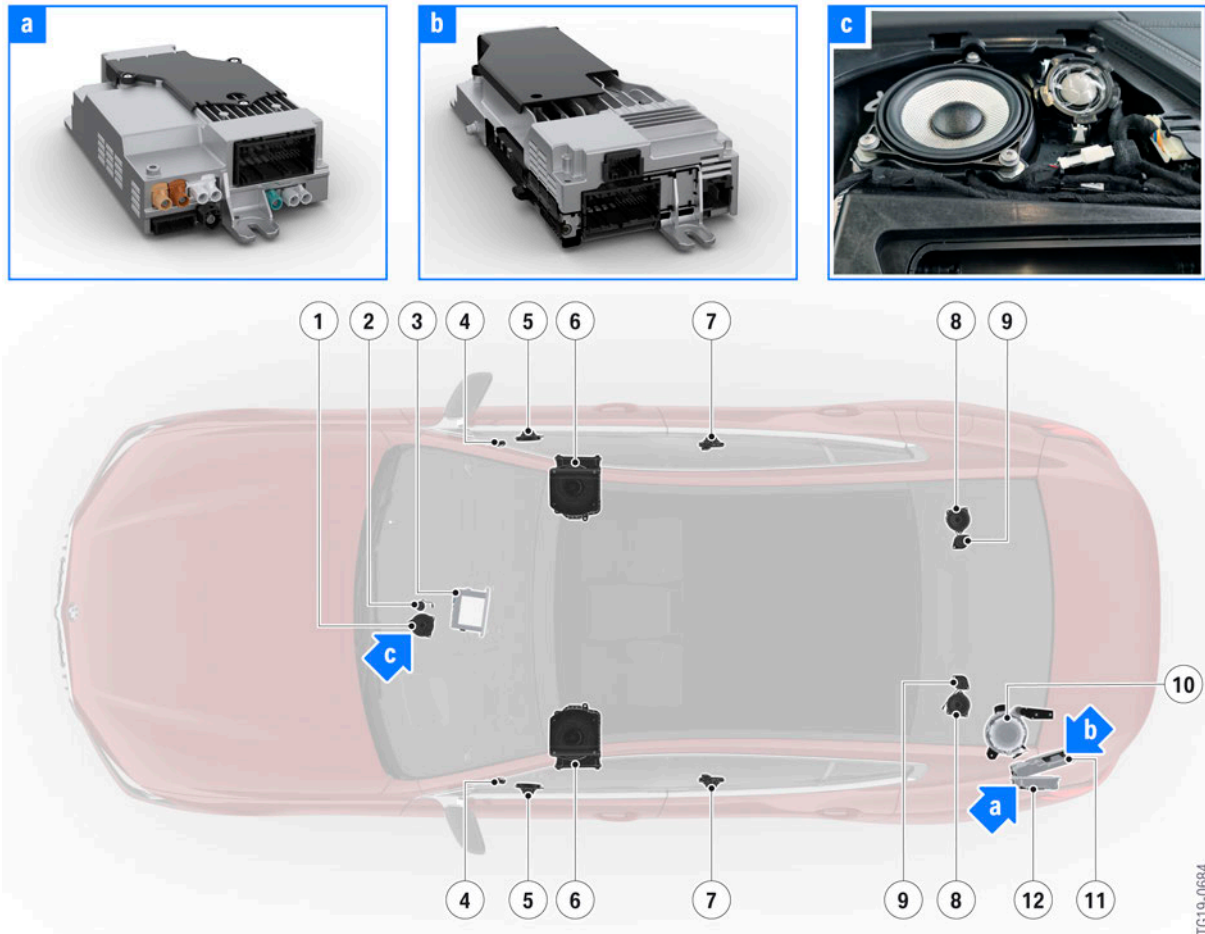

G16 High-end audio system overview

Index	Explanation
1	Mid-range speaker, front center
2	Tweeter, front center
3	Head unit
4	Diamond tweeters
5	Mid-range speaker, front
6	Bass speakers
7	Mid-range speaker, rear
8	Mid-range speaker, parcel shelf
9	Tweeter, parcel shelf
10	Speakers for outside sound (OE 1MA)
11	Booster
12	Receiver Audio Module (RAM)

G16 Complete Vehicle.

9. Infotainment.

9.2.3. Sound settings

Special sound settings are incorporated in the sound settings menu of the High-end audio system.

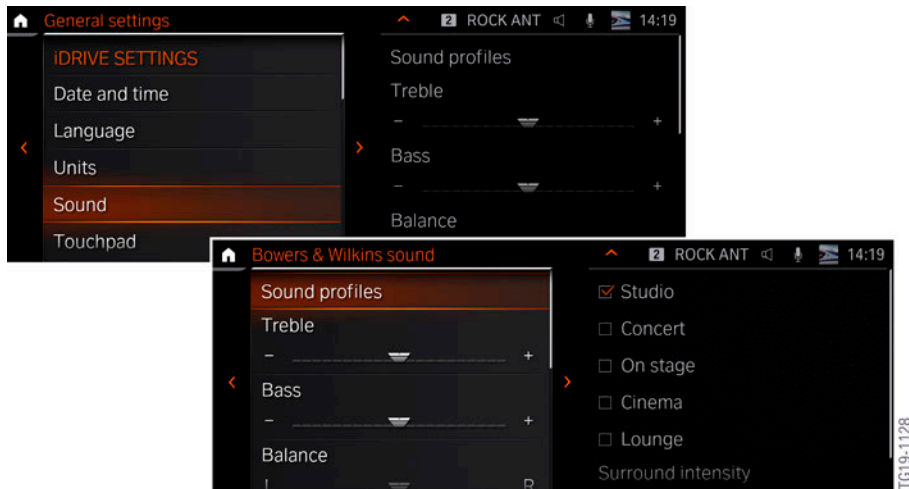

High-end audio system sound settings

The sound settings feature five different sound profiles which, depending on the setting selected, change the activation of the speakers in the vehicle. The intensity of the surround effects can also be adjusted.

G16 Complete Vehicle.

9. Infotainment.

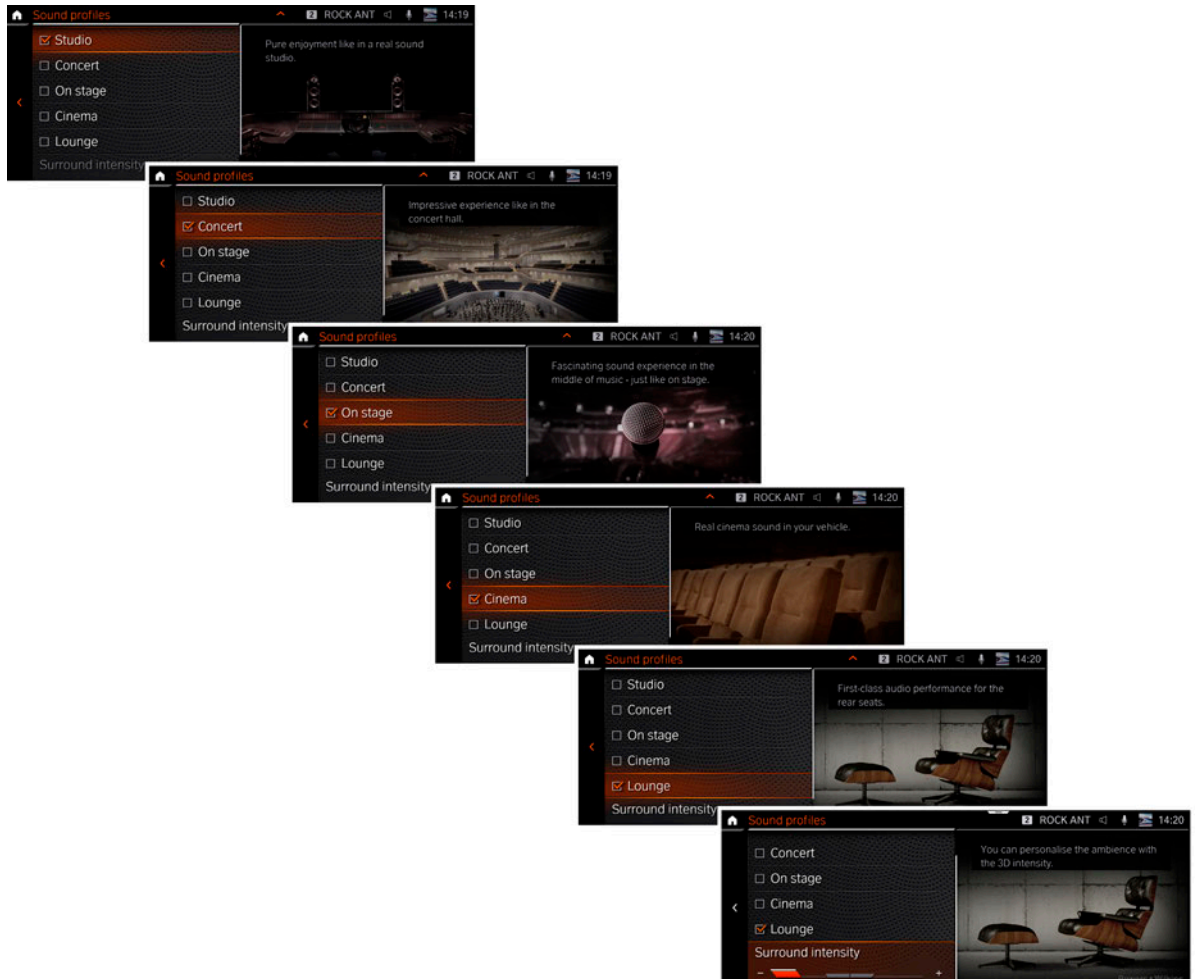

Sound profiles

The highs and lows can be individually adjusted with the equalizer.

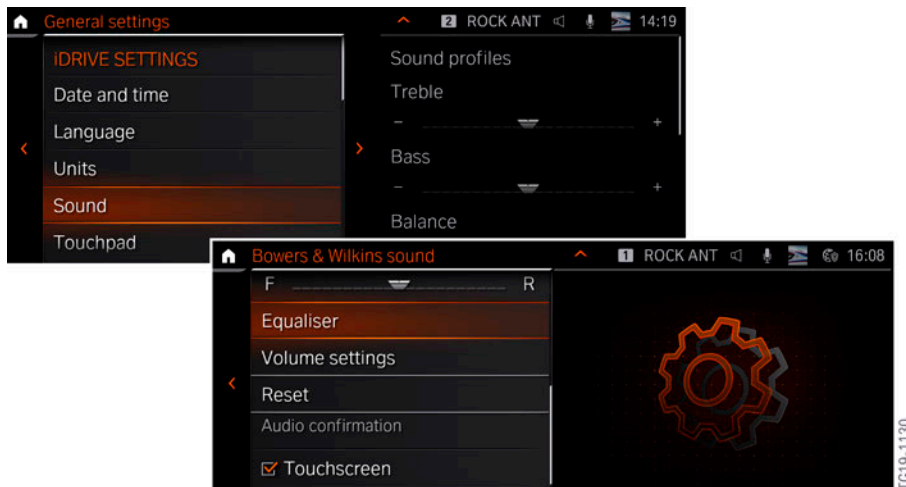

High-end audio system equalizer

G16 Complete Vehicle.

9. Infotainment.

The equalizer enables different frequencies to be increased and decreased.

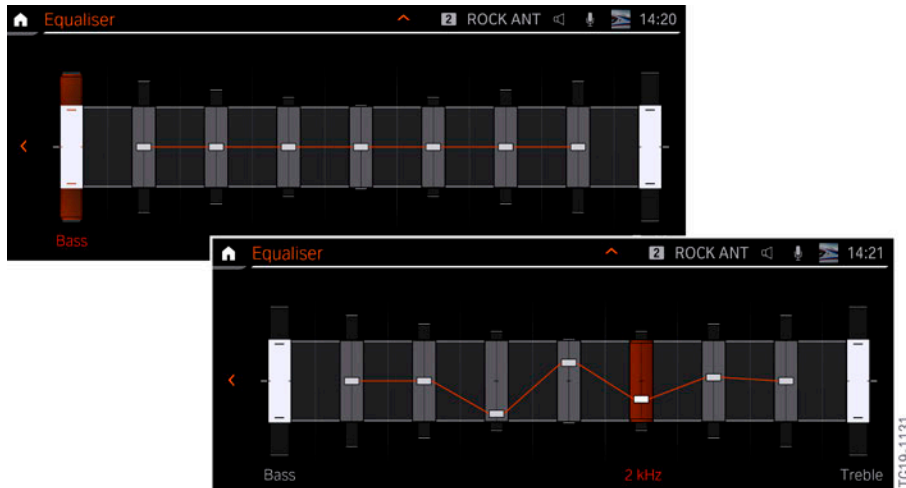

Equalizer settings

9.3. Telematic Communication Box 3

The Telematic Communication Box 3 TCB3 is installed in the G16. Compared with the TCB2 the following new features are integrated:

- Higher data transfer (up to 300 Mbit/s)
- LTE advanced (4.5 G) compatible
- Improved security standard (IPSEC)
- The WiFi hotspot is no longer in the TCB, but instead integrated in the head unit.

Due to the design of the roof, the Telematic Communication Box 3 is installed in the luggage compartment.

G16 Complete Vehicle.

9. Infotainment.

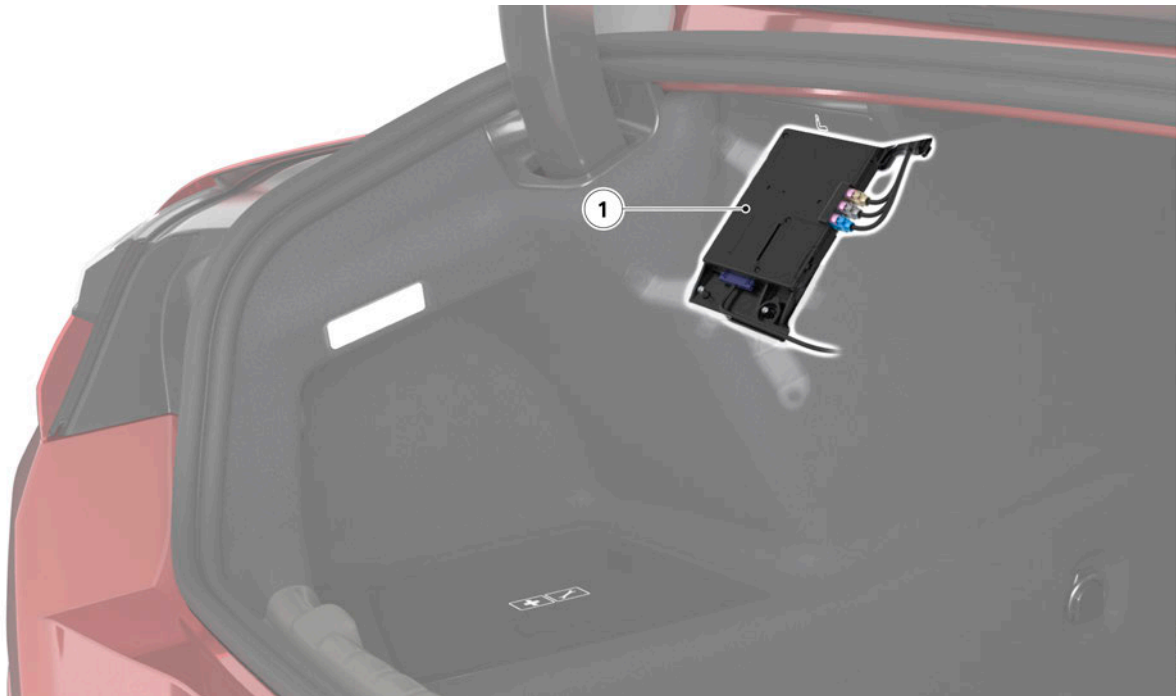

TCB3 in the G16 luggage compartment

Index	Explanation
1	Telematic Communication Box 3 (TCB3)

9.4. ConnectedDrive

ConnectedDrive receives a new offer structure concept. Some services can no longer be ordered from the factory with ID7, but only via the BMW ConnectedDrive Store.

Other services are offered in packages, which are compatible with the equipment when ordering the vehicle. For example, with the purchase of a navigation system the equipment Real Time Traffic Information is also offered.

9.4.1. Offer structure

Different ConnectedDrive packages are offered to the customer which extend the range of functions with additional functions and services.

The ConnectedDrive services (SA 6AK) are already contained in all the equipment packages. These **cannot** be ordered individually.

All services offered in packages can also be ordered individually or through the BMW ConnectedDrive Store.

G16 Complete Vehicle.

9. Infotainment.

9.4.2. BMW Live Cockpit Professional

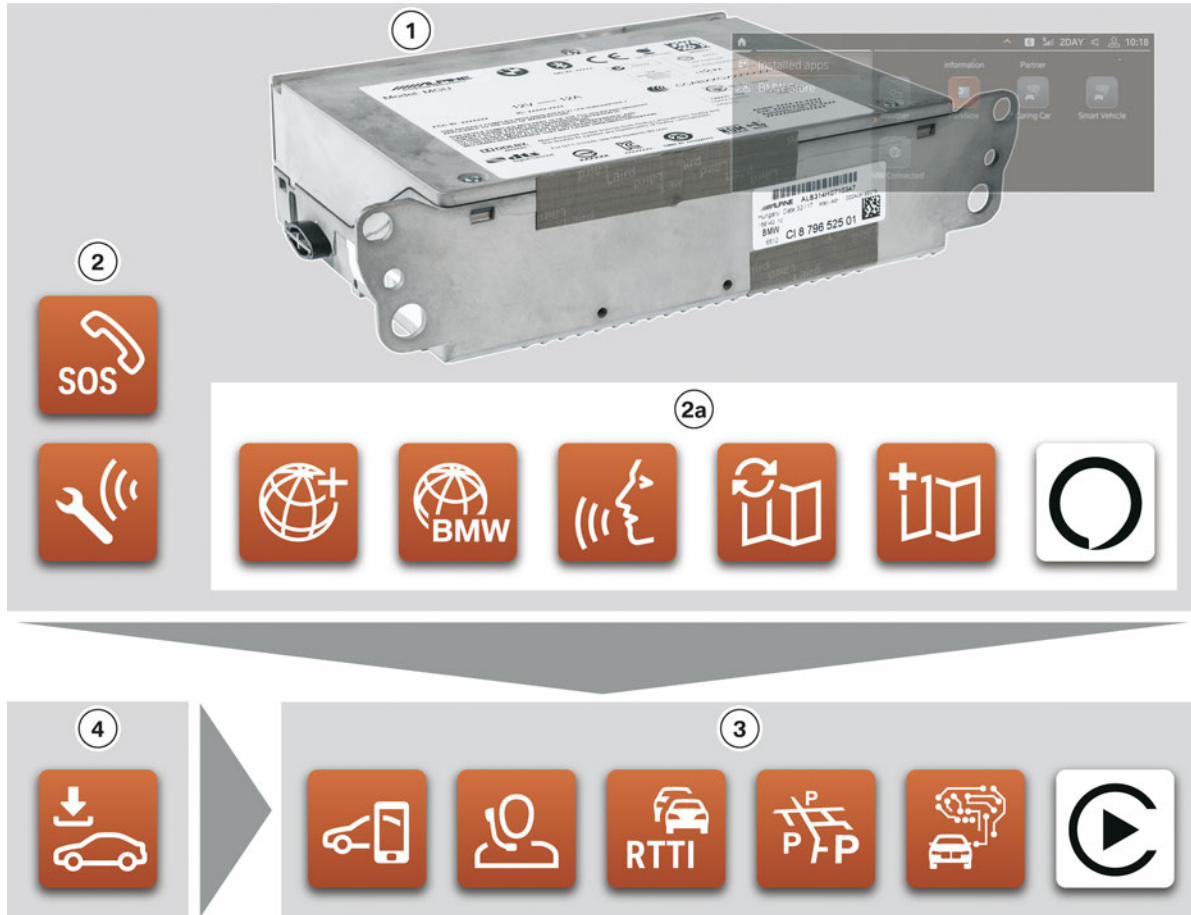

G16 Complete Vehicle.

9. Infotainment.

Index	Explanation
1	BMW Live Cockpit Professional (SA 6U3) (Head Unit High 3 (HU-H3))
2	<p>The following services are included in the standard equipment:</p> <ul style="list-style-type: none">• BMW Assist eCall• BMW TeleService <p>These services are limited in their duration and can be rebooked as required.</p>
2a	<p>The following services are included in the BMW Live Cockpit Professional equipment:</p> <ul style="list-style-type: none">• BMW Connected+• Vehicle apps• Update map data (complete and partial update)• Natural Language Understanding (NLU) <p>These services are limited in their duration and can be rebooked as required.</p>
3	<p>Standard equipment Connected Package Professional (SA 6C4):</p> <ul style="list-style-type: none">• Remote Services• Concierge Service• Apple® CarPlay preparation• Advanced Real-Time Traffic Information• On-Street Parking Information• In-Car-Experience• Connected Navigation <p>These services are limited in their duration and can be rebooked as required.</p>
4	BMW ConnectedDrive Store (can be called up via customer portal, BMW Connected app or in the vehicle)

In the G16 BMW Live Cockpit Professional is already installed as standard equipment and the current offer structure (07/19) is used. In this offer structure the Intelligent Functions are no longer assigned to the Connected Package Professional, but instead to the BMW Live Cockpit Professional equipment. The service In-Car-Experience is featured in the Connected Package Professional.

9.5. BMW Intelligent Personal Assistant

Interaction with the vehicle is revolutionized with the BMW Intelligent Personal Assistant. It provides a basis for the new digital character in the vehicle. The generic term BMW Intelligent Personal Assistant describes a multitude of functions and services which are implemented by means of voice input, BMW Connected app, cloud services or from machine learning.

The BMW Intelligent Assistant is **not** a single item of optional equipment for the vehicle. Rather, established but also new functions are summarized and combined with each other under the term BMW Intelligent Personal Assistant. This makes it easier for the customer to operate all manner of functions since they always have a vehicle expert as a contact. This will over time learn more and more

G16 Complete Vehicle.

9. Infotainment.

about the vehicle user and acquire further functions by Remote Software Upgrade. The prerequisite for the BMW Personal Assistant is the equipment **Live Cockpit Professional** (SA6U3) with a **Head Unit High 3** (HU-H3).

9.5.1. Activation

The BMW Intelligent Personal Assistant can be activated without having to press a button. Two settings are available for activation.

- Standard activation with "Hello BMW"
- Personalized activation with an individualized form of address, such as e.g. Joy or Mona Lisa.

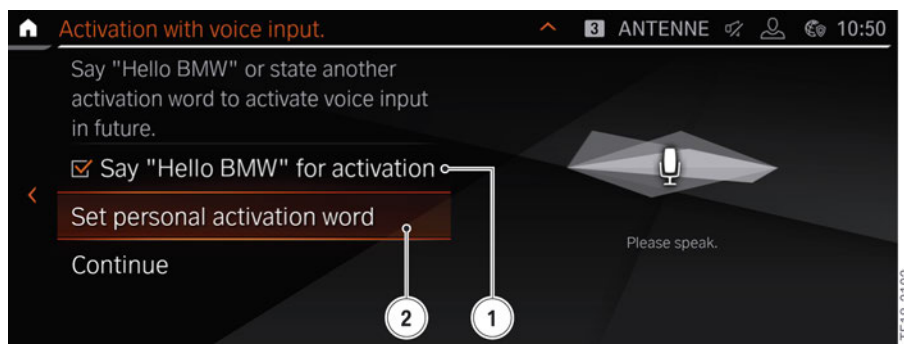

Activation variants

Index	Explanation
1	Activate "Hello BMW" to start the BMW Intelligent Personal Assistant
2	Define individual activation word via iDrive or speaking the word



A multisyllabic word is recommended (Lisa-Marie, Mona Lisa) for better recognition of a personal activation word. This ensures activation and prevents the possibility of accidental activation by the activation syllable being used in the general flow of speech in the vehicle.



Speaking the individual activation word is only possible with an active online connection and is valid for the entire vehicle. Changing the activation word in one profile changes the activation word in all the profiles.

9.5.2. Scope of function

The BMW Intelligent Personal Assistant comprises a number of areas within the vehicle. The following table shows a summary of the different areas.

G16 Complete Vehicle.

9. Infotainment.

Interaction	Vehicle expert	Assistant	Across systems
Recognition of the customer via the Personal Profile	Explanation of the functions in the vehicle	Run navigation via voice control	Concierge Service
Recognition and storing of habits	Activate, deactivate or change functions in the vehicle by means of voice control	Control Office applications, such as e.g. calendar, e-mails	Alexa (Amazon®)
Individual activation word to start the BMW Intelligent Personal Assistant		Adapt entertainment functions	Siri (Apple®)

9.5.3. Interaction

Interaction with the BMW Intelligent Personal Assistant is performed with natural voice control. If the BMW Intelligent Personal Assistant is for example activated with "Hello BMW, who are you?", the BMW Intelligent Personal Assistant is explained with text and video.

To enable the method of operation of the BMW Intelligent Personal Assistant to be used to optimum effect, information such as e.g. name, seat settings, last destination and similar are stored in the driver profile. Some of these data are also synchronized with the BMW Cloud.

The BMW Intelligent Personal Assistant automatically activates functions in the vehicle which were previously defined in the settings or with the aid of the BMW Connected app. For example, the seat heating is activated when the temperature drops below a preset level.

9.5.4. Vehicle expert

The BMW Intelligent Personal Assistant knows the vehicle and can communicate appropriate information to the customer. For example, the BMW Intelligent Personal Assistant can relay statistics concerning the last travel route, such as for instance the route driven or the average speed.

The BMW Intelligent Personal Assistant also offers access to the integrated owner's guide. With the activation "Hello BMW, how do I activate the High Beam Assistant?", the BMW Intelligent Personal Assistant explains to the customer how to activate the High Beam Assistant.

The BMW Intelligent Personal Assistant can also relay the status of the vehicle, such as e.g. tire pressure or oil level.

9.5.5. Assistant

The BMW Intelligent Personal Assistant can control navigation and the entertainment system. With the activation "Hello BMW, I want to go home" the BMW Intelligent Personal Assistant activates the home address as the destination.

